

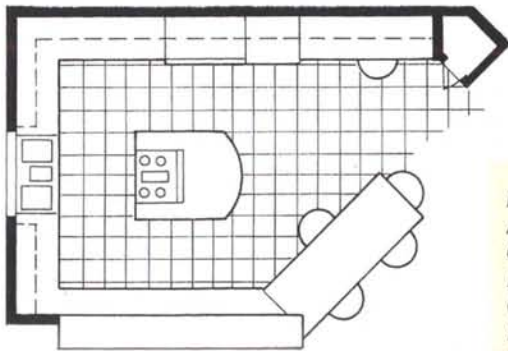

Hub Of The Home

In Tucson, a centrally located kitchen serves as a plan's pivotal point.



Green hued granite and teal ceramic tile add color to the predominant tone of oak cabinets in this Tucson kitchen. The flooring is Southwestern clay tile.

Major Products Used

Appliances: G.E.
Cabinets: KraftMaid.
Doors: Southwest Door Company.
Fireplace: Temco.
Home Controls/Automation: Honeywell.
Plumbing Fixtures: Grohe, Kohler.
Windows: Weathershield.

When a couple began planning their 3200-square-foot retirement house in Tucson, Ariz., the wife asked architect Alexandra Hayes, Tucson, for a kitchen where she could always be part of the activity in the house. Hayes' solution was to put the kitchen in the center of the house, with the living, dining, and family rooms radiating off this hub.

The house was built on a hillside site, with three levels stepping down the hill. The major rooms are open. The kitchen looks out on the dining and family rooms, a breakfast bar separates the kitchen area and family room, and a partial wall conceals kitchen clutter from the dining room.

The homeowners' preference for arched and curved shapes is expressed in the kitchen, where an arched opening above the sink aligns with a window overlooking the foyer. The arched theme is repeated in the shape of the island, the light cove above it, and the breakfast bar, crafted of oak with a cherry, butcher-block top.

"Because the room is an interior space, we put a large skylight in the ceiling," says builder Brian Olson, Olson-Hannah Building Co. Inc., Tucson. The skylight is surrounded by a light cove containing indirect lighting and down spots. Clay tile flooring and light oak cabinets give this kitchen a warm, rustic feel.

Hard costs for the house ran \$112 a square foot. **-A.P.**